

OUT-LOOKS

# FOCUS ON TECHNOLOGY

## FRESH BREEZE



Photo by Porsche

*The special features exist in the details, so it is worth taking a closer look—especially at the 918 Spyder concept car. Its striking features include what are known as ram-air intakes above the V8 mid-engine. Dr. Gernot Döllner, the 918's project director, tells us more.*

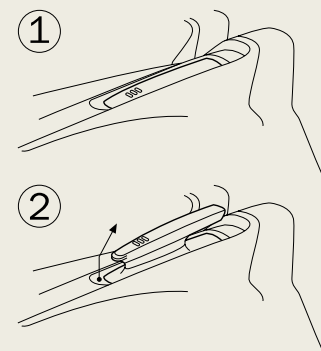

“The two ram-air intakes on the 918 Spyder extend as a function of driving mode and speed, which means they are among the active elements of the car’s aerodynamics system. In addition to its sports-oriented basic design, Porsche’s high-performance plug-in hybrid can take on different looks. Its largely closed body structure features an aerodynamic profile with low drag, which is especially

advantageous for efficient engine operations with low fuel consumption (1). For performance-oriented driving, the body structure opens up in racing mode by means of the extendable rear wing and ram-air intakes (2). At high speeds, these intakes boost the combustion engine’s injection capability and thus yield a slight increase in performance.”